

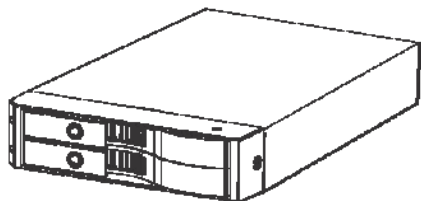

MR-25DRE

External 2,5" enclosure
for 2x 2,5" HDD



User Manual

Introduction

The FANTEC MR-25DRE is an external 2 bay enclosure for standard 9.5mm SATA HDDs. The tool-free design is very easy and provides quick HDD installation.

Features

Material	Plastics & Metall
Interface	USB 2.0 & eSATA
LED indication	Power on & HDD Access
OperationSystem	Windows 2000/XP/Vista/7/MAC OS 9 and above/Linux
Dimension:(LxWxH)	101mm(W) x 153mm(D) x 25mm(H)
Safety Certificate	CE and FCC approval
Disk type	2.5"SATA I & II HDD & SSD
Raid Mode	JBOD, BIG, RAID0, RAID1
Power Adapter	5V, 2A

Mobile Rack HDD Installation

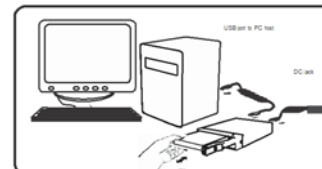
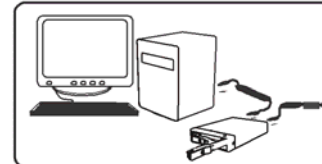
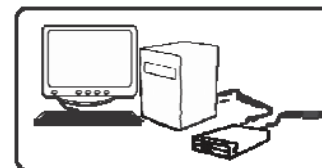

JBOD MODE (Single)

Non-RAID (JBOD single mode): The computer will show up 2 independent drives. This function is the default setting when you use only one HDD or 2 HDD (even different models) are installed.

RAID 0 MODE (Stripping)

Stripping is a method of concatenating multiple HDDs into one logical unit. It is the automated process of writing data across multiple HDDs simultaneously. Stripping is used to increase the performance. The data are written in "column" effect. If one HDD fails, all data are lost.

RAID 1 (Mirroring)

Mirroring is the automated process of writing data to multiple HDDs simultaneously. It is used to provide data redundancy. If one HDD fails, the other HDD will continue to store the data and provide access to it. The failed HDD can be replaced and the rebuilt will start automatically.

BIG MODE (Spanning)

Spanning concatenates a series of physical (same or different) HDD into a single large volume. The data are written firstly at HDD1 and then to HDD2. If one HDD fails, all data are lost.

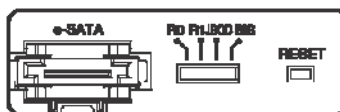

Package contents

Model: MR-25DRE
Interface: 1x USB 2.0 connector
1x eSATA connector
Raid mode: Raid0, Raid1, JBOD, BIG
Package: External enclosure
USB 2.0 cable
eSATA Cable
User manual
Key, Power Adapter

LED indication MR-25DRE

LED Off	No HDD inserted
LED Blue Steady	HDD inserted
LED Pink Blinking	HDD Write / Read Access HDD Rebuilding
LED Red/Blue Blinking	HDD not initialized HDD faulty

To initialize HDDs, please set preferred RAID mode and press RESET button.

When the MR-25DRE in rebuilding, the LED of the new HDD will continues blink pink, and the LED of the other HDD will blink slowly.